

Belmont Skating Rink

Schematic Design

October 3rd, 2022

Reduced Option

Value Engineering Deductions

Eliminate 2 Harris Field locker rooms (2,316 sf)

Eliminate DPW Shop (993 sf)

Scale Back Rink Entrance Mezzanine (2,919 sf)

Eliminate White Field House Demolition

Reduce scale for parking and entrance plaza



TGAS THE GALANTE ARCHITECTURE STUDIO

PROPOSED

Proposed Site Plan



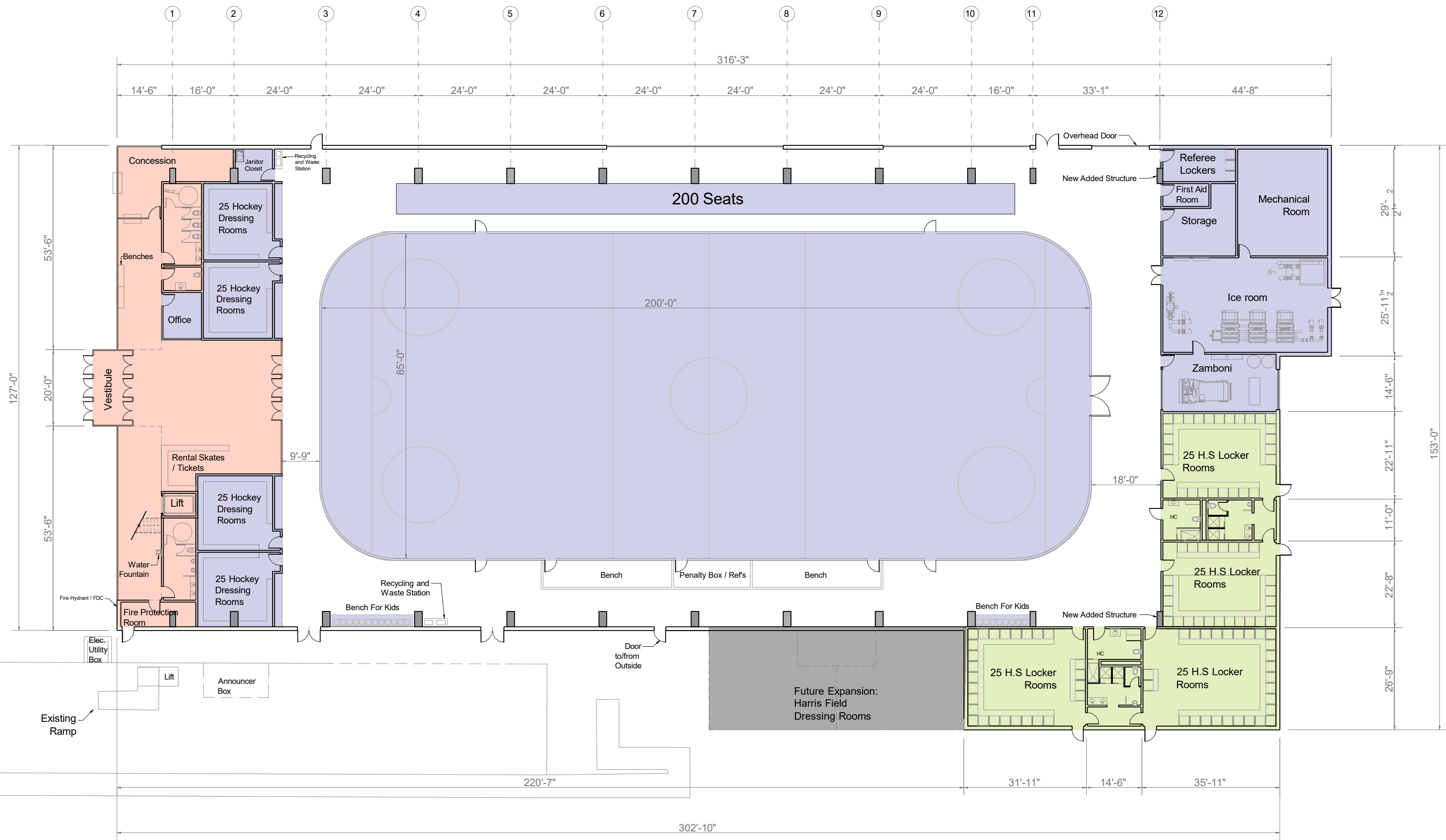

TGAS
THE GALANTE ARCHITECTURE STUDIO

PROPOSED

Proposed Ground Floor Plan ± 41,465 sf



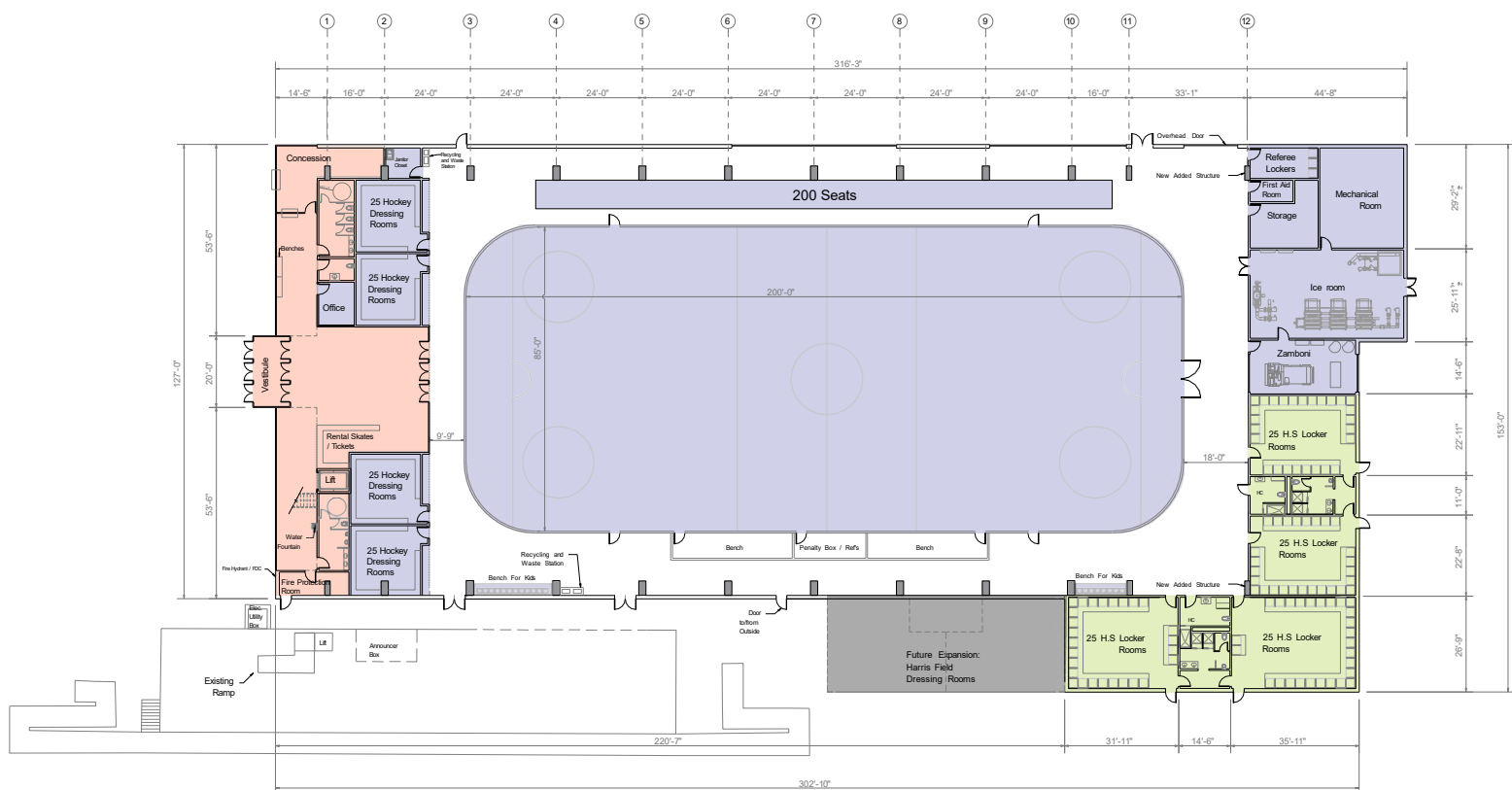
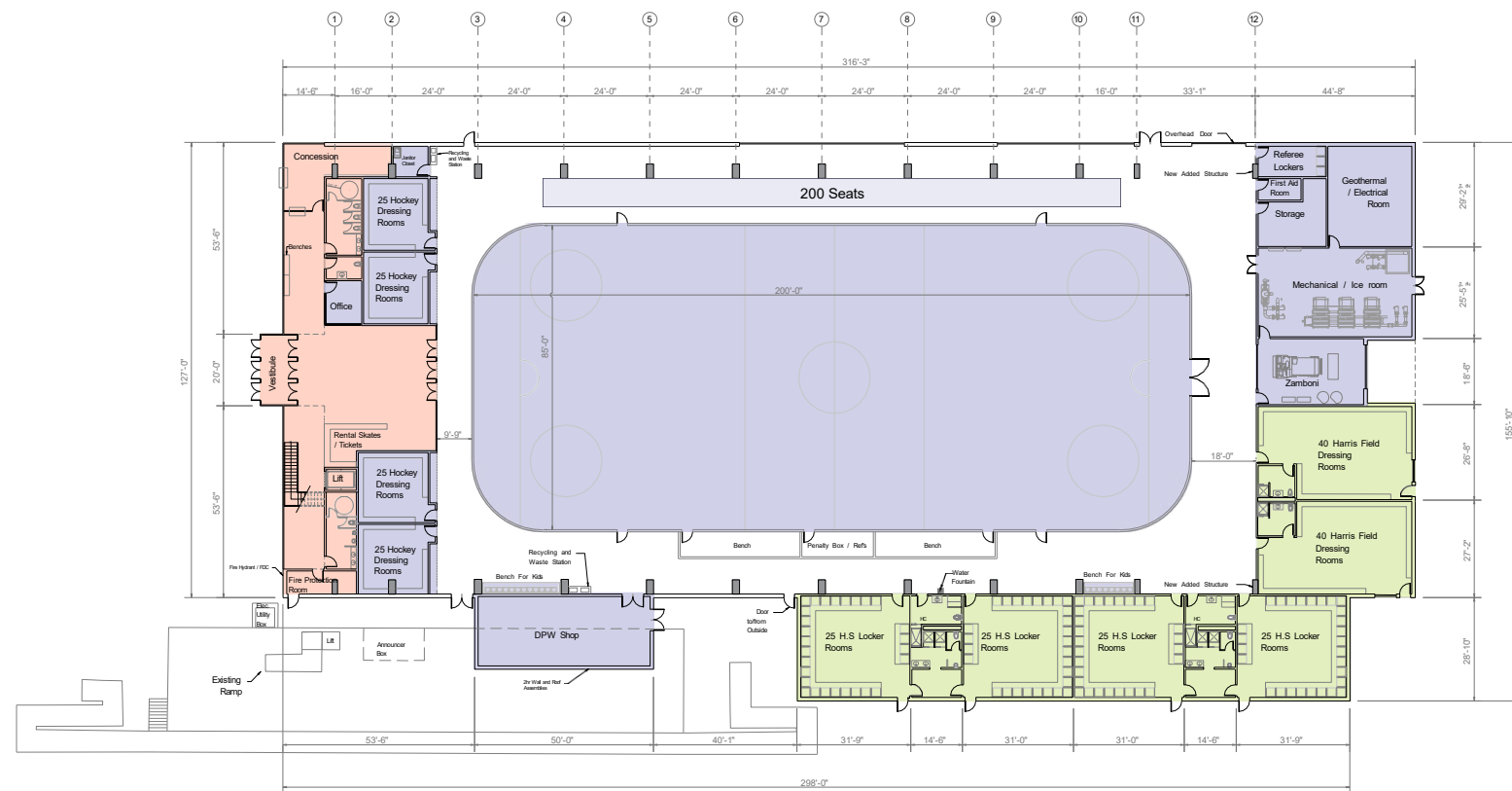
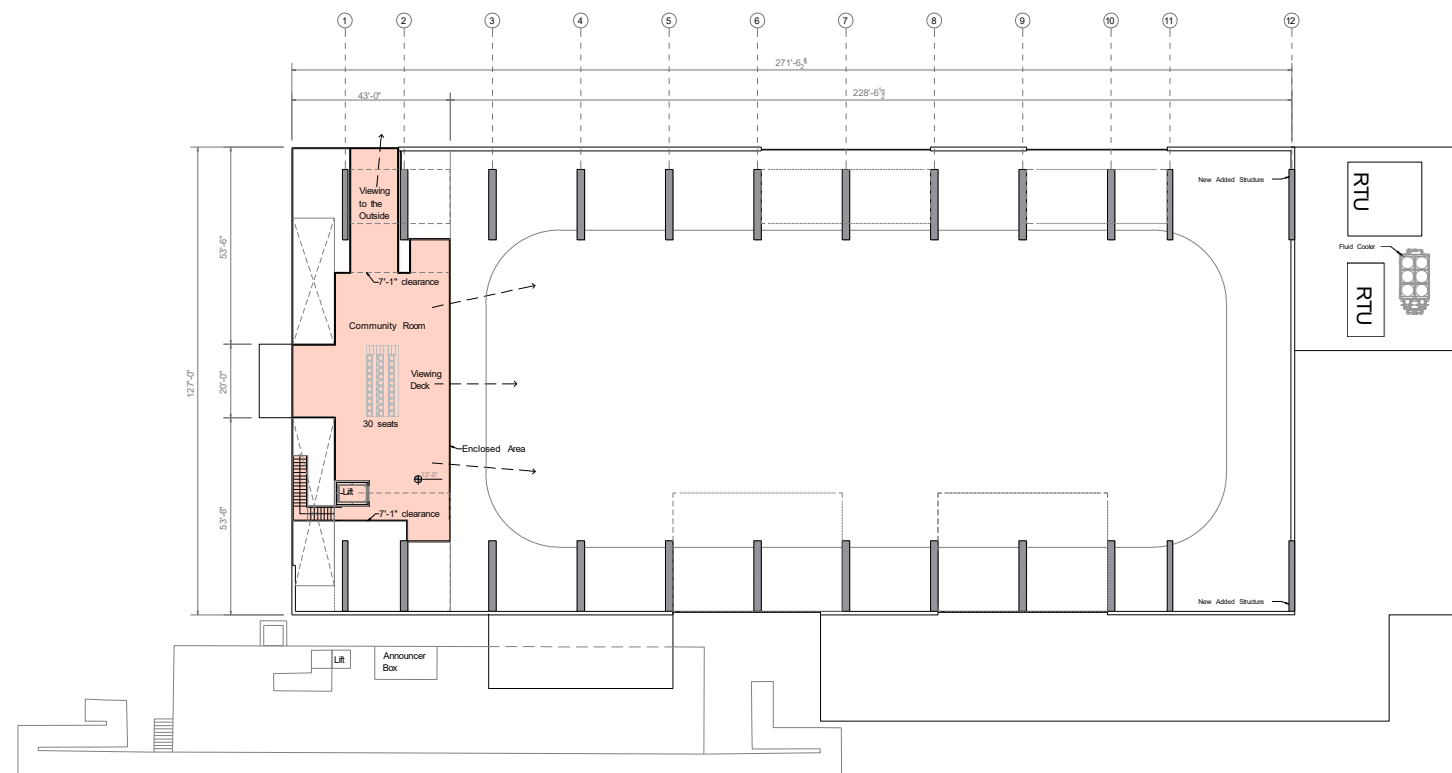

Proposed (41,465 sf)
 VS
 Previous (48,800 sf)



TGAS
THE GALANTE ARCHITECTURE STUDIO



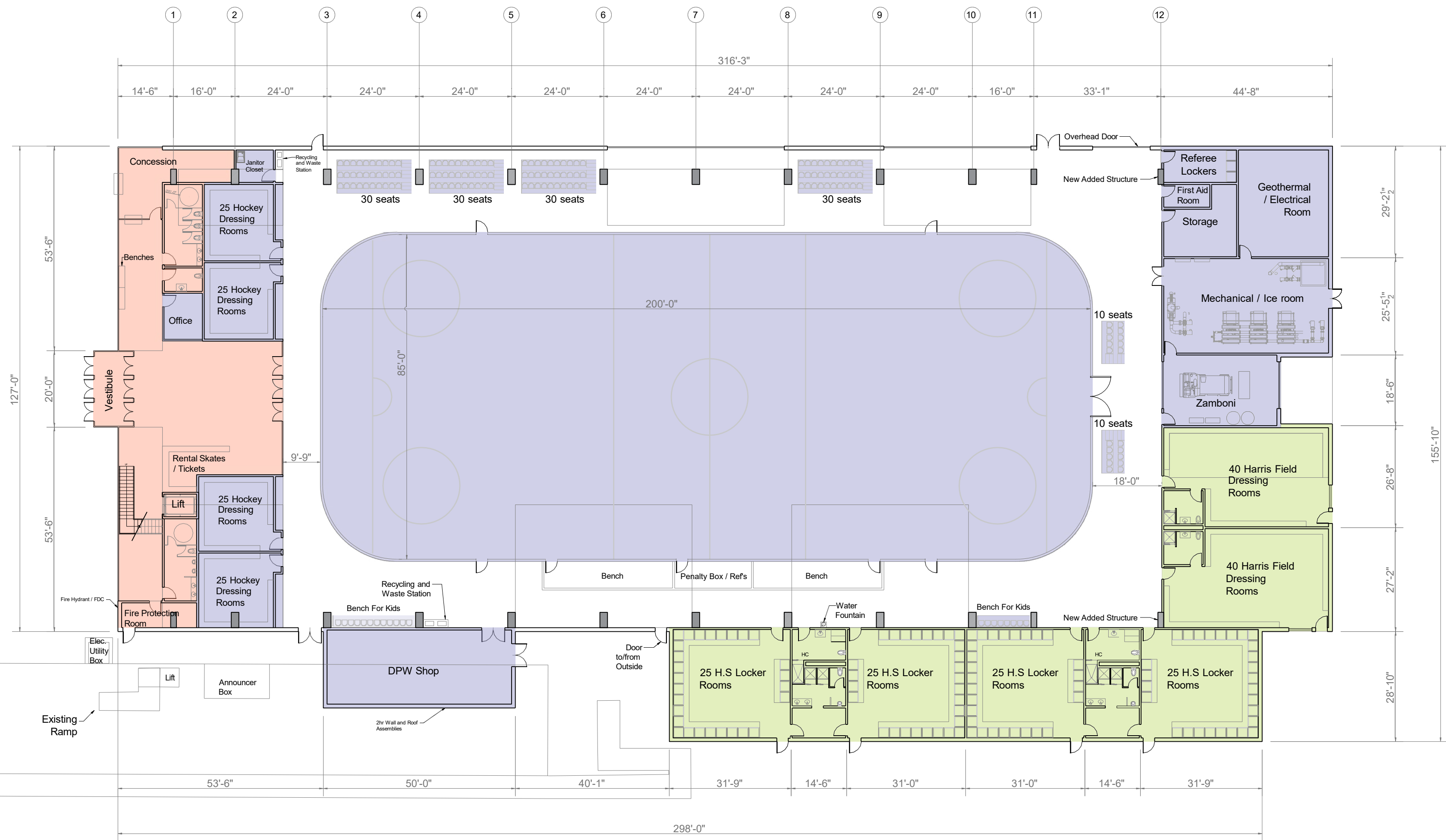

TGAS
THE GALANTE ARCHITECTURE STUDIO

PREVIOUS

Previous Ground Floor Plan ± 45,740



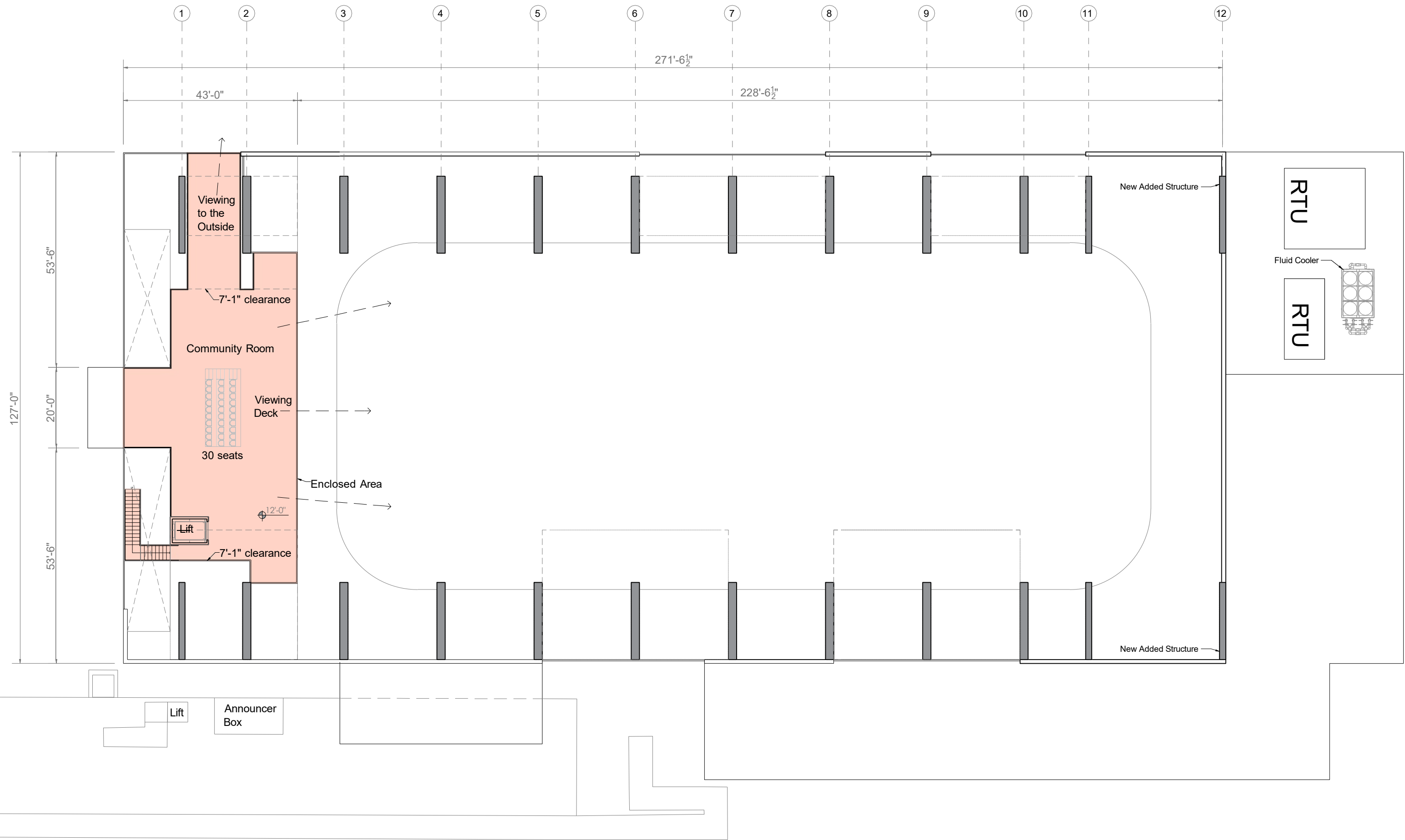

TGAS
THE GALANTE ARCHITECTURE STUDIO

PREVIOUS

Previous Mezzanine Floor Plan ± 2,960 sf



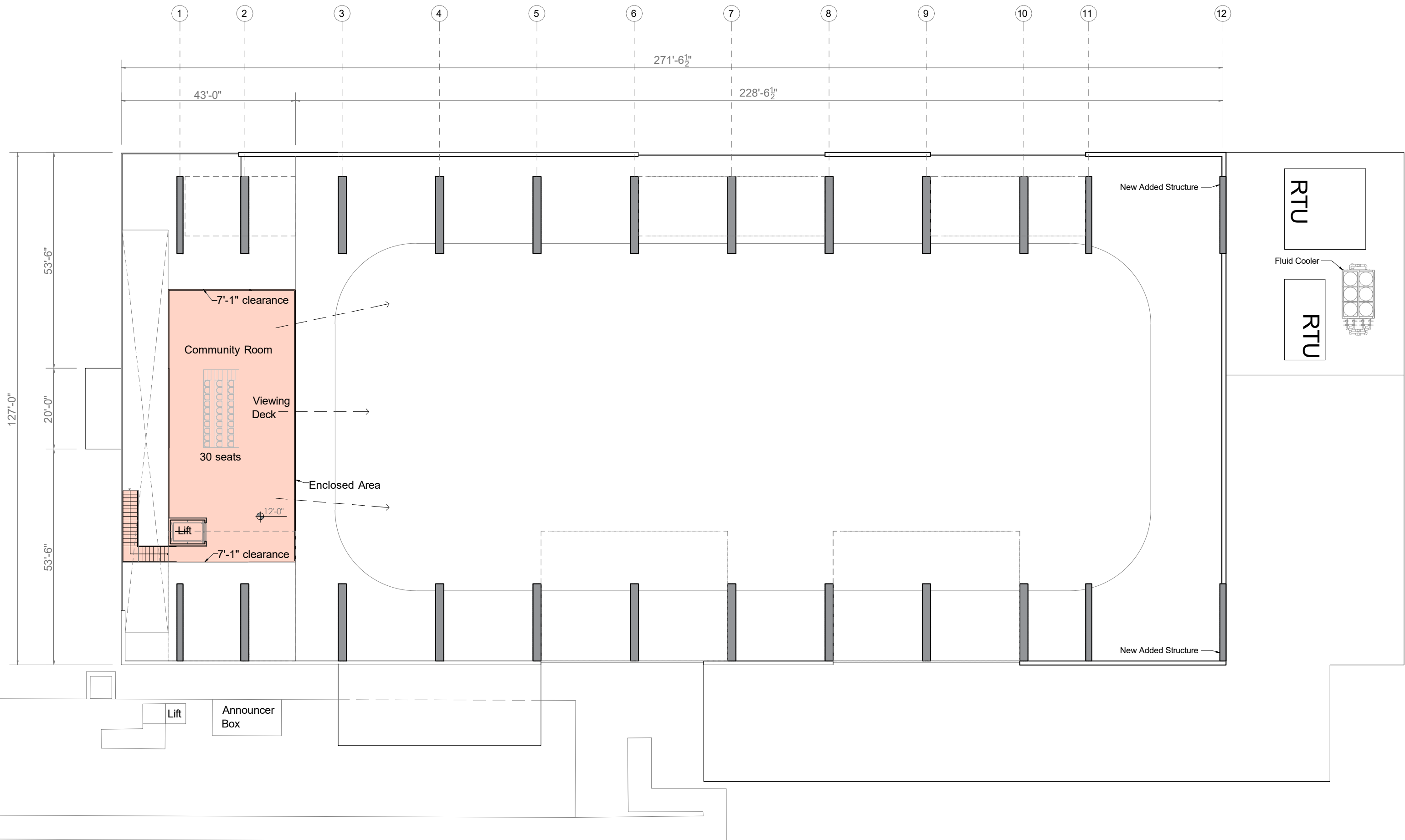

Proposed Mezzanine Floor Plan ± 2,121 sf

TGAS
THE GALANTE ARCHITECTURE STUDIO

PROPOSED

